

Dwyer

SERIES DBV

BRASS BALL VALVE

Full Port, Economical, 600 psi (41 bar)

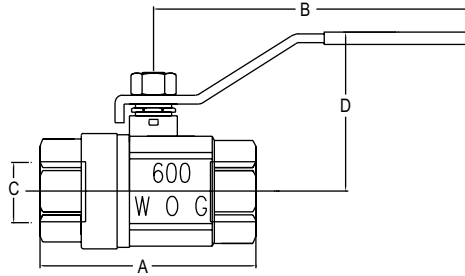

| NPT Size | A in [mm] | B in [mm] | C in [mm] | D in [mm] |
|----------|------------------|------------------|-----------------|------------------|
| 1/4" | 1-39/64 [40.89] | 3-5/32 [80.01] | 5/16 [7.87] | 1-47/64 [43.94] |
| 3/8" | 1-45/64 [43.18] | 3-5/32 [80.01] | 25/64 [9.91] | 1-13/16 [45.97] |
| 1/2" | 2-3/16 [55.63] | 3-55/64 [98.04] | 19/32 [15.24] | 2-11/64 [55.12] |
| 3/4" | 2-23/64 [59.94] | 3-55/64 [98.04] | 3/4 [19.05] | 2-9/32 [57.91] |
| 1" | 2-7/8 [72.90] | 4-13/32 [112.01] | 63/64 [24.89] | 2-11/16 [68.07] |
| 1-1/4" | 3-5/16 [84.07] | 4-51/64 [121.92] | 1-17/64 [32.00] | 3-5/32 [80.01] |
| 1-1/2" | 3-47/64 [95.00] | 5-7/16 [137.92] | 1-9/16 [39.88] | 3-55/64 [98.04] |
| 2" | 4-13/32 [112.01] | 5-7/16 [137.92] | 1-31/32 [50.04] | 4-13/64 [106.93] |
| 2-1/2" | 5-53/64 [148.08] | 8-1/2 [215.90] | 2-31/64 [62.99] | 4-61/64 [125.98] |
| 3" | 6-29/64 [163.83] | 8-1/2 [215.90] | 2-61/64 [74.93] | 5-1/8 [130.05] |

The **Series DBV Brass Ball Valve** is an economical hand lever ball valve ideal for commercial or general industrial use. The Series DBV is the ideal choice for a manual shut off valve, along with many other applications. Valve body, body cap and ball are made of a quality brass for great durability. Seats and stem packing are constructed of PTFE for long lasting service as well. Blowout-proof stem provides safety in the event of overpressure. Full port design allows for maximum Cv while still retaining minimal pressure drop.

BENEFITS/FEATURES

- Low cost
- Blowout-proof stem

APPLICATIONS

- Gas or liquid flow control

SPECIFICATIONS

Service: Gases and liquids compatible with wetted materials.

End Connections: 1/4 to 3" female NPT.

Pressure Limits: -29" Hg to 600 psi (-736 mm Hg to 41 bar) WOG.

Temperature limit: -40 to 365°F (-40 to 185°C).

Wetted Materials: Body and body cap: Brass; Ball: Chrome plated brass; Stem: Brass; Seat and packing: PTFE.

Other Materials: Body gland and stem nut: Brass; Handle cover: Rubber; Handle: steel.

MODEL CHART

| Model | Pipe Size | Model | Pipe Size |
|--------|-----------|--------|-----------|
| DBV-00 | 1/4" | DBV-05 | 1-1/4" |
| DBV-01 | 3/8" | DBV-06 | 1-1/2" |
| DBV-02 | 1/2" | DBV-07 | 2" |
| DBV-03 | 3/4" | DBV-08 | 2-1/2" |
| DBV-04 | 1" | DBV-09 | 3" |

USA: California Proposition 65

WARNING: This product can expose you to chemicals including Lead, which is known to the State of California to cause cancer and birth defects or other reproductive harm. For more information go to www.P65Warnings.ca.gov.