



## SERIES DBVL & SWBV | LOW LEAD BRASS BALL VALVES



### BENEFITS/FEATURES

- Low lead brass
- PTFE seats to stem
- Blowout-proof stem

### APPLICATIONS

- Gas or liquid flow control

### DESCRIPTION

The **Series DBVL & SWBV Low Lead NPT Brass Ball Valves** are economical hand lever ball valves ideal for commercial or industrial use where lead content is regulated. The valve body, body cap, and stem are made of a quality low lead brass for great durability and compatibility. The seats and stem packing are constructed of PTFE for long lasting service. A blowout-proof stem provides safety in the event of overpressure, and the full port design allows for the maximum flow coefficient while still retaining minimal pressure drop.

### SPECIFICATIONS

<b>Service</b>	Gases and liquids compatible with wetted materials.
<b>End Connections</b>	DBVL: 1/4" to 3" female NPT; SWBV: 1/4" to 3" sweat connections.
<b>Pressure Limits</b>	1/4" to 2": -29" Hg to 600 psi (-736 mm Hg to 41 bar) WOG; DBVL: 2-1/2" to 3": -29" Hg to 250 psi (-736 mm Hg to 17 bar) WOG; SWBV: 2-1/2" to 3", -29" Hg to 400 psi (-736 mm Hg to 27 psi) WOG.
<b>Temperature Limits</b>	-40° to 365°F (-40° to 185°C).
<b>Wetted Materials</b>	Body, body cap, and stem: Brass; Seat and packing: PTFE; Ball: DBVL: 1/4" to 1": Chrome plated brass; 1-1/4" to 3": SS; SWBV: SS.
<b>Other Materials</b>	Body gland and stem nut: Brass; Handle and handle nut: Steel; Handle cover: Rubber.
<b>Agency Approvals</b>	Meets the technical requirements of EU Directive 2011/65/EU (RoHS II).

## DIMENSIONS

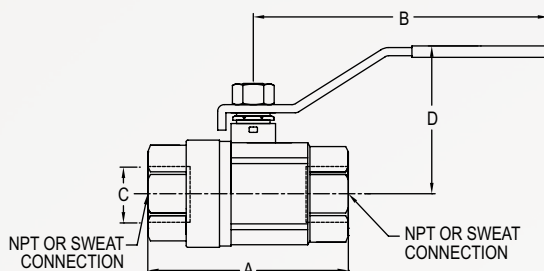

DBVL DIMENSIONS				
NPT Size	A in [mm]	B in [mm]	C in [mm]	D in [mm]
1/4"	1-3/4 [45]	3-5/32 [80]	25/64 [10]	1-47/64 [44]
3/8"	1-3/4 [45]	3-5/32 [80]	25/64 [10]	1-47/64 [44]
1/2"	2-3/64 [52]	4-1/64 [102]	19/32 [15]	1-7/8 [47.5]
3/4"	2-23/64 [60]	4-1/64 [102]	3/4 [19]	2-1/64 [51]
1"	2-3/4 [70]	4-17/32 [115]	63/64 [25]	2-23/32 [69]
1-1/4"	3-5/16 [84]	5 [127]	1-17/64 [32]	3-1/32 [77]
1-1/2"	3-21/32 [93]	5-19/32 [142]	1-37/64 [40]	3-45/64 [94]
2"	4-3/16 [106]	5-19/32 [142]	1-31/32 [50]	4 [101]
2-1/2"	5-3/8 [137]	8-21/32 [220]	2-33/64 [64]	4-49/64 [121]
3"	6-1/32 [153]	8-21/32 [220]	2-29/32 [74]	5-5/64 [129]

SWBV DIMENSIONS				
NPT Size	A in [mm]	B in [mm]	C in [mm]	D in [mm]
1/4"	1-55/64 [47]	3-5/32 [80]	23/64 [9]	1-47/64 [44]
3/8"	1-55/64 [47]	3-5/32 [80]	1/2 [13]	1-47/64 [44]
1/2"	2-15/64 [57]	3-55/64 [98]	5/8 [16]	2-15/64 [57]
3/4"	2-51/64 [71]	3-55/64 [98]	7/8 [22]	2-23/64 [60]
1"	3-35/64 [90]	4-13/32 [112]	1-1/8 [29]	2-45/64 [69]
1-1/4"	4-1/8 [105]	4-51/64 [122]	1-3/8 [35]	3-3/64 [77]
1-1/2"	4-11/16 [119]	5-7/16 [138]	1-5/8 [41]	3-51/64 [96]
2"	5-35/64 [141]	5-7/16 [138]	2-1/8 [54]	4-5/32 [105]
2-1/2"	6-39/64 [168]	8-3/16 [208]	2-41/64 [67]	4-63/64 [126]
3"	6-57/64 [175]	9-11/16 [246]	3-13/32 [87]	5-1/16 [129]

## HOW TO ORDER

Use the **bold** characters from the chart below to construct a product code.

DBVL		-00	
SERIES		SIZE	
DBVL: Low lead NPT brass ball valve		-00: 1/4"	
SWBV: Low lead sweat brass ball valve		-01: 3/8"	
		-02: 1/2"	
		-03: 3/4"	
		-04: 1" (SWBV only)	
		-05: 1-1/4" (SWBV only)	
		-08: 2-1/2"	
		-09: 3"	

**ORDER ONLINE TODAY!**

[dwyer-inst.com/Product/SeriesDBVL-SWBV](http://dwyer-inst.com/Product/SeriesDBVL-SWBV)

USA: California Proposition 65  
 ⚠ WARNING: Cancer and Reproductive Harm - [www.P65Warnings.ca.gov](http://www.P65Warnings.ca.gov)



**DWYER INSTRUMENTS, LLC**

©Copyright 2021 Dwyer Instruments, LLC  
 Printed in U.S.A. 12/21

DS-DBVL-SWBV Rev. 1

Important Notice: Dwyer Instruments, LLC reserves the right to make changes to or discontinue any product or service identified in this publication without notice. Dwyer advises its customers to obtain the latest version of the relevant information to verify, before placing any orders, that the information being relied upon is current.