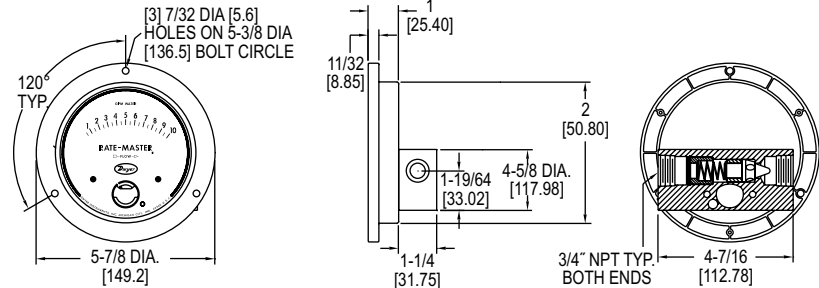

SERIES RMVII

RATE-MASTER® DIAL-TYPE FLOWMETER

For Panel Mounting, Three Ranges to 10 GPM Water, High Pressure Limits

CALIBRATION SERVICES AVAILABLE

*FITS IN ANSI STANDARD 4.940 [125.5] PANEL CUTOUT

The **Series RMVII Rate-Master® Dial-Type Flowmeter** consists of a machined brass meter body which is ideally suited for water flows with $\pm 5\%$ of full-scale accuracy. Body design fits standard 4-1/2" mounting hole layouts per ANSI B40.1. Inlet and outlet threads are standard 3/4" female NPT.

BENEFITS/FEATURES

- Unique construction fully isolates flowing media from gage front for leak-proof operation at pressures up to 3000 psig (206.7 bar)
- Target-type design combined with a damage resistant magnetic linkage, drive a pointer over easy-to-read litho scale
- Shatter proof construction, unlike glass tube variable area flowmeters, yields long operation life

APPLICATIONS

- Monitor coolant flow through ingot heaters, high-amp switchgear, resistance welders, heat exchangers, compressors, scrubbers
- Monitor water consumption to different processes and operations for more efficient operations
- Calculate required fill or drain times for tanks, water towers

OPTIONS

To order add suffix:	Description
-NIST	NIST traceable calibration certificate
Example: RMVII-1-NIST	

SPECIFICATIONS

Service: Compatible gases, liquids and oils.

Wetted Materials: Brass, 302 SS, sintered barium ferrite, polyacetyl.

Temperature Limit: 200°F (93°C).

Pressure Limit: 3000 psig (206 bar).

Pressure Drop: 0 to 5 GPM: 3.2 psid;
0 to 10 GPM: 5.3 psid; 0 to 20 GPM:
10.4 psid.

Accuracy: $\pm 5\%$ of FS.

Size: Diameter dial face 4.5" (114.3 mm).

Process Connections: 3/4" female NPT.

Weight: 2 lb, 14 oz (1.3 kg).

MODEL CHART

Model	Range GPM Water	Range SCFM	Range LPM Air	Range GPM Oil	Range LPM Oil
RMVII-1	0 to 3	-	-	-	-
RMVII-3	0 to 5	-	-	-	-
RMVII-6	0 to 10	-	-	-	-
RMVII-10	-	0 to 10	0 to 280	-	-
RMVII-12	-	0 to 30	0 to 850	-	-
RMVII-14	-	0 to 50	0 to 1400	-	-
RMVII-20	-	-	-	0 to 2.2	0 to 8
RMVII-21	-	-	-	0 to 4.0	0 to 15
RMVII-22	-	-	-	0 to 8.5	0 to 32

USA: California Proposition 65

WARNING: This product can expose you to chemicals including Lead, which is known to the State of California to cause cancer and birth defects or other reproductive harm. For more information go to www.P65Warnings.ca.gov.