

SIGHT FLOW METERS

SPDT or Pulse Output, Visual Flow Confirmation, Brass Body

Flow Transmitters,
Paddlewheel, In-Line



SF2-1



SF2-2

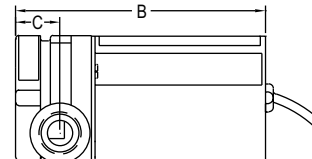
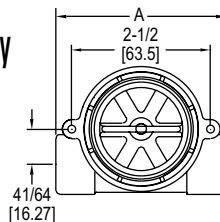

Side view VAC switch models

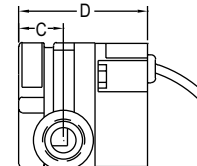

Side view VDC switch and transmitter models

DIMENSIONS in [mm]

Model	A	B	C	D	Model	A	B	C	D
SF2-104	3-1/64 [76.6]	-	7/8 [22.23]	2-21/64 [59.13]	SF2-134	3-61/64 [100.41]	-	1-1/16 [26.99]	2-61/64 [75]
SF2-101	3-1/64 [76.6]	4-1/2 [114.3]	7/8 [22.23]	-	SF2-131	3-61/64 [100.41]	4-49/64 [121.05]	1-1/16 [26.99]	-
SF2-114	3-1/64 [76.6]	-	7/8 [22.23]	2-21/64 [59.13]	SF2-204	3-1/64 [76.6]	-	13/16 [20.64]	2-21/64 [59.13]
SF2-111	3-1/64 [76.6]	4-1/2 [114.3]	7/8 [22.23]	-	SF2-214	3-1/64 [76.6]	-	13/16 [20.64]	2-21/64 [59.13]
SF2-124	3-61/64 [100.41]	-	1-1/16 [26.99]	2-61/64 [75]	SF2-224	3-61/64 [100.41]	-	1-1/16 [26.99]	2-61/64 [75]
SF2-121	3-61/64 [100.41]	4-49/64 [121.05]	1-1/16 [26.99]	-	SF2-234	3-61/64 [100.41]	-	1-1/16 [26.99]	2-61/64 [75]

The **Series SF2 Sight Flow Meters** combine visual confirmation of flow with a relay or pulse output. The SF2-1 offers a SPDT relay output and the SF2-2 offers a pulse output proportional to the rate of flow. The 4.5-24 VDC pulse output is compatible with most digital logic families.

BENEFITS/FEATURES

- Brass, solid body construction, one piece composite rotor, and ceramic shaft delivers durability with broader chemical, temperature, and pressure capabilities
- Set points are fully adjustable over the specified flow range
- The dynamic operation of the rotor guards against jamming and false actuation

APPLICATIONS

- Cooling and lubrication circuits
- HVAC systems
- Aggressive chemical metering
- Batching systems

MODEL CHART - SPDT RELAY OUTPUT

Model	Range (GPM)	Power	Connection
SF2-104	0.5 to 5.0	24 VDC	1/4" female NPT
SF2-101	0.5 to 5.0	110 VAC	1/4" female NPT
SF2-114	4.0 to 20.0	24 VDC	1/2" female NPT
SF2-111	4.0 to 20.0	110 VAC	1/2" female NPT
SF2-124	5.0 to 30.0	24 VDC	3/4" female NPT
SF2-121	5.0 to 30.0	110 VAC	3/4" female NPT
SF2-134	8.0 to 60.0	24 VDC	1" female NPT
SF2-131	8.0 to 60.0	110 VAC	1" female NPT

SPECIFICATIONS

Service: Liquids compatible with wetted parts.

Wetted Materials: Brass body, ceramic pin, PPS rotor, Polysulfone lens and fluororelastomer O-ring.

Accuracy: Relay output: $\pm 5\%$; Pulsed output: $\pm 7\%$ for ranges up to 5.0 GPM, $\pm 15\%$ for ranges up to 60.0 GPM.

Temperature Limits: -20 to 212°F (-29 to 100°C).

Pressure Limit: 200 psig (13.8 bar) @ 70°F.

Power Requirements: See table.

Output: SPDT: 1 Amp, 24 VDC resistive; 0.3 Amp, 110 VAC or 4.5-24 VDC pulse depending on model.

Electrical Connections: Relay output models: 20AWG PVC-jacketed, 24" cable; Pulsed output models: 22AWG PVC-jacketed, 24" cable.

Process Connections: See table.

Set Point Differential: 15% max for relay output models.

Maximum Viscosity: 200 SSU.

Compliance: CE.

MODEL CHART - PULSED OUTPUT

Model	Range (GPM)	Power	Connection
SF2-204	0.5 to 5.0	4.5-24 VDC	1/4" female NPT
SF2-214	4.0 to 20.0	4.5-24 VDC	1/2" female NPT
SF2-224	5.0 to 30.0	4.5-24 VDC	3/4" female NPT
SF2-234	8.0 to 60.0	4.5-24 VDC	1" female NPT

USA: California Proposition 65

WARNING: This product can expose you to chemicals including Lead, which is known to the State of California to cause cancer and birth defects or other reproductive harm. For more information go to www.P65Warnings.ca.gov.